

## Brandon Marsh Measures

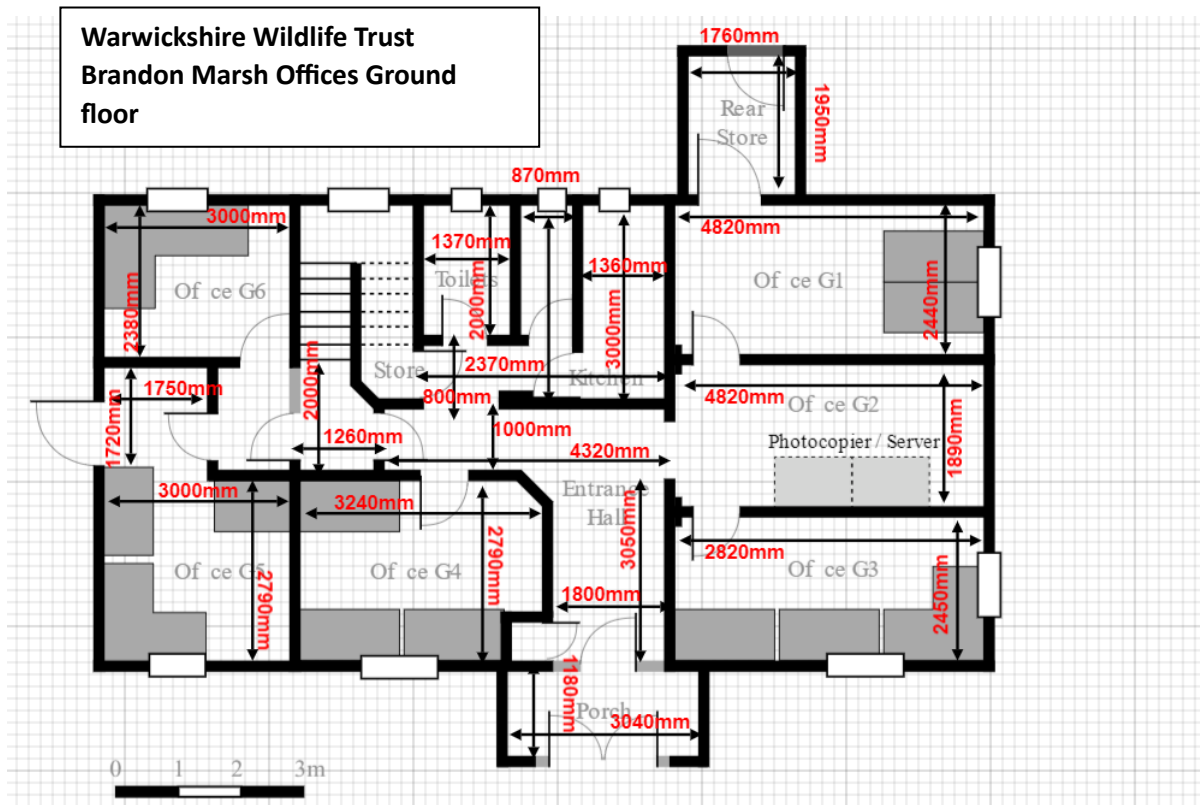

Ground floor office SQ meterage approx. – 85 sqm

First floor office SQ meterage approx.- 93 sqm



Visitor centre square meterage approx. – 273 sqm

Warwickshire Wildlife Trust  
Brandon Marsh Classroom & Barn

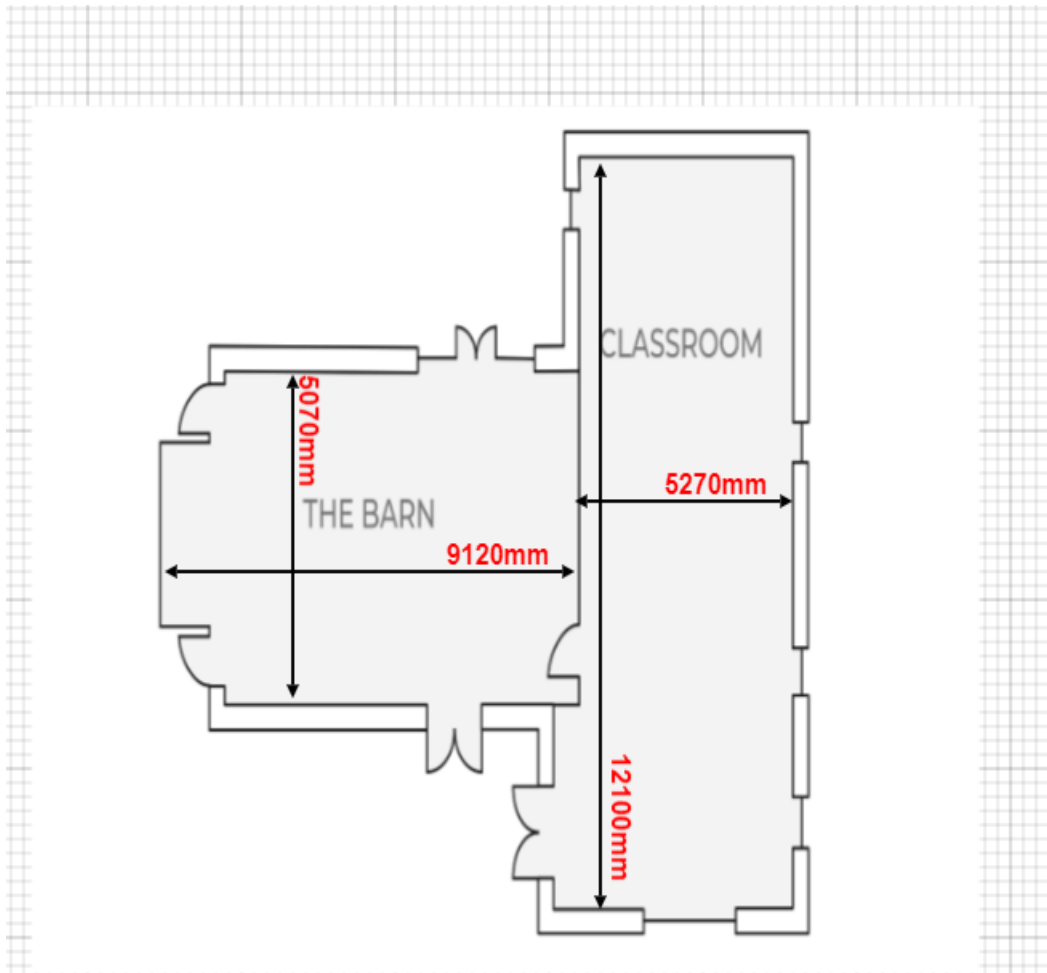

**Barn square meterage approx. – 46 sqm**

**Classroom square meterage approx. – 63 sqm**